

FP3 Labor & Birth Pool Installation Guide

Variant: Overflow; Version: 1.1 EN-USA

READ ALL INSTRUCTIONS CAREFULLY BEFORE INSTALLATION

Handling The Pool

- DO NOT remove pool from delivery packaging in a cargo handling area
- AT LEAST 3 able-bodied people are required to move the pool
- REMOVE abrasive or sharp items (e.g. jewellery, tools) from persons and the work area before handling the pool
- ALWAYS use a covering to protect the pool from abrasion prior to installation
- CAREFULLY re-orientate the pool to measure the base and location of the lag bolts prior to installation, ensuring no deformation occurs prior to measuring.

Pre-Installation Procedures

Please note: there are manufacturing variations on each pool and specifications are subject to change as we improve upon our product. The manufacturer accepts a variance +/- 3/8" on the nominal dimensions. In view of this, the exact dimensions needed for installation should be measured directly from the delivered pool. Edel Immersys assumes no responsibility for preparatory work.

A good knowledge of construction techniques, plumbing and electrical installation in accordance with local codes of practice is required for proper installation. We recommend that a qualified contractor performs the installation of all Edel Immersys products. Our warranty does not cover issues arising from improper installation.

Handling The Pool

- 1

Prior to shipment, all pools are inspected, filled with water and operated at our manufacturing facility to ensure product quality and watertight operation.
- 2

Upon receiving your FP3 pool, inspect it thoroughly for freight damage. Should inspection reveal any damage, do not install the pool. Instead, record/photograph the damage and contact us immediately.
- 3

Rough handling may cause leaks and a watertight operation should be re-checked prior to installation.

WARNING

- Do not lift the pool by any portion of the plumbing.
- Do not stand in the pool during construction.
- FAILURE TO FOLLOW THESE WARNINGS DURING INSTALLATION WILL RESULT IN TERMINATION OF THE WARRANTY. DAMAGE OR DEFECT CLAIMED AFTER THE POOL IS INSTALLED IS NOT COVERED UNDER THE WARRANTY.

Drawings

All dimensions in inches [mm]

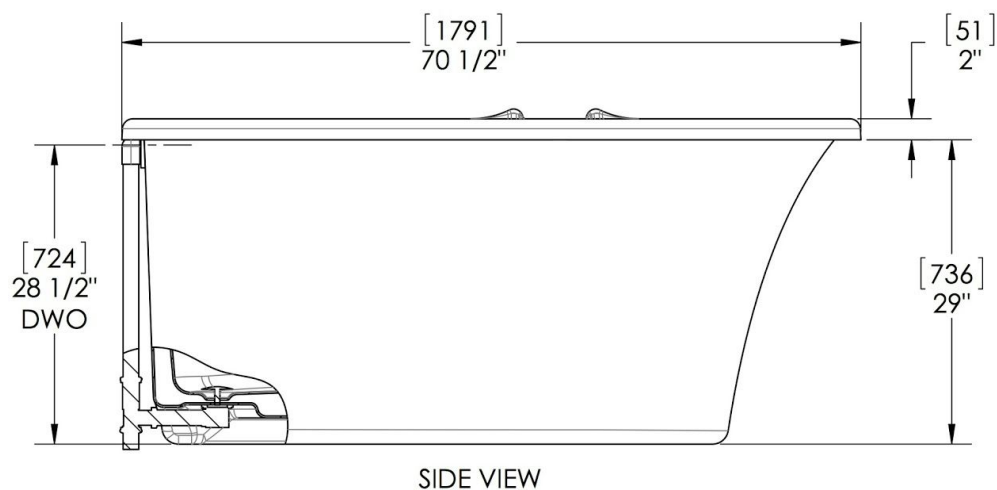
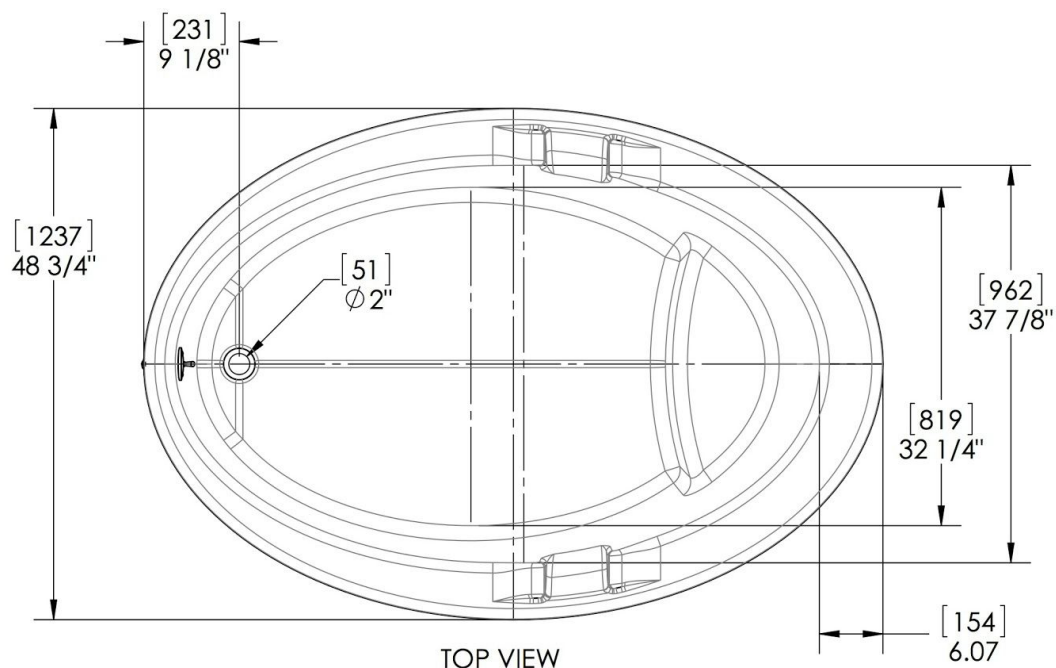

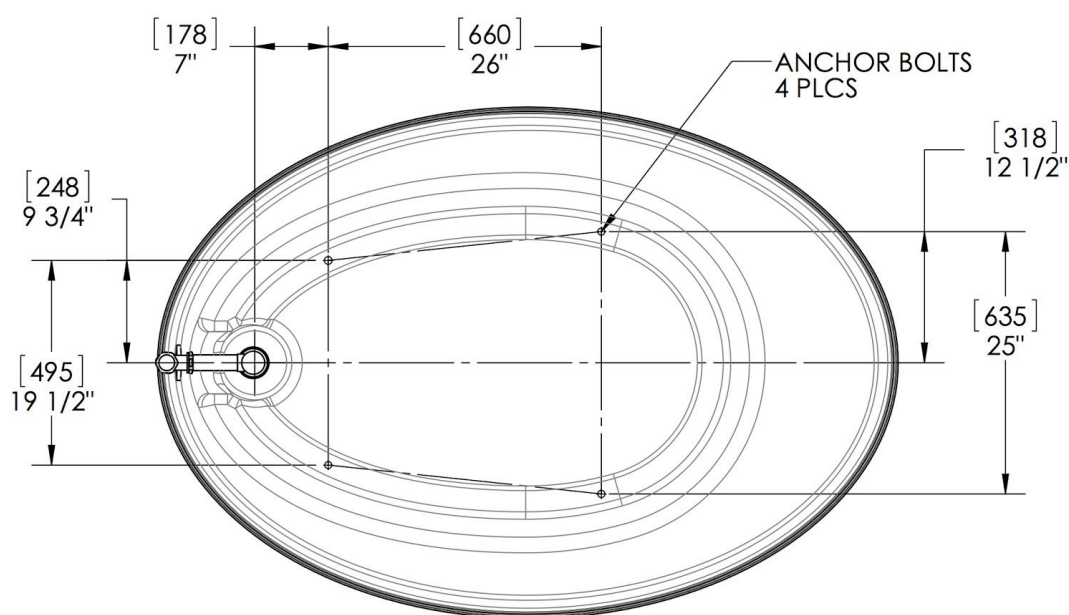

BOTTOM VIEW

Structural Preparation

Note: The Pool Should Remain In Its Shipping Carton Until Time Of Installation.

1	As noted above, the dimensions provided are for reference only. Actual dimensions for your pool should be taken directly before installation.
2	Total weight of the pool filled to overflow is 1,276 lbs. Check your floor can support this additional weight including people and other equipment e.g. furniture.
3	The drain fitting will protrude below the base of the pool approximately 11/2". Clearance may be needed for the drain: either (a) cut away the subfloor (if possible) or (B) raise the pool by the use of a suitable and adequately strong support structure.
4	Freestanding units must be placed on a perfectly levelled floor (see Preparation Step 1 below).
5	Wall mounted or freestanding faucets must be used (the pool is not designed to enable integrated faucets).
6	Check to ensure that your installation will conform to all applicable codes and secure necessary permits, e.g. building codes.
7	All plumbing connections should be made by a qualified plumber.
8	Damage or leaks claimed after the pool is installed are not covered under the warranty.

NOTE: Achieving a watertight installation of the drain and overflow of the pool is the responsibility of the installer. Drain and/or overflow leakage problems are not covered by the warranty.

Preparation Steps

1	Check if floor is exactly level. If not, lay a bed of cement mortar to provide a level base for the pool. Remember to take account of the location of the drain as it enters the sub-floor.
2	Determine the exact location of the pool and trace the footprint of the pool on the floor or mortar base with an erasable marker pen;
3	Determine the exact location of the drain and the anchoring points at each end of the pool.
4	To prevent the pool from moving sideways, secure the anchoring pins (3/8" x 3" lag bolts, not supplied) to the floor. Leave the lag bolts 1 1/2" above floor. Wipe off the marker tracings.
5	Install the overflow and drain on the pool. Cut pipes to desired length prior to assembly. Glue the first pipe section (PVC 1 1/2") to go under the floor. Apply a silicone seal under the rim of the base and lay the pool down with lag bolts through the holes in the pool and putting the pipes through the floor. Immediately remove any excess silicone.

Water Supply

The pool requires a 3/4" separate hot and cold water supply feeding into mixer tap/faucet with a throw of 6" +/-1" (assuming no more than 1" horizontal distance from pool deck to wall). The faucet outlet should be 33" above the floor level plus the height of any cement bed.

Maximum water temperature into bath recommended 110 ° F (43 ° C) to prevent scalding. The target filling time is 20 minutes, therefore the desired flow rate at temp of 100 ° F (38 ° c) is 390gph. Maximum recommended filling time is 30 minutes.

A high degree of control over filling time and temperature can be achieved using a thermostatic mixing valve, such as Armstrong Sense DMV3 (www.armstronginternational.com in the Hot Water > Water Temperature Controls section). This is recommended and has infection control features including non-touch and timed self-flushing. In some countries outside the USA the same device is supplied by RADA as model RADA Sense Bath T3.

Waste Water Plumbing

The pool comes with a chrome drain-waste overflow. The 1 1/2" tail-piece leads into the sub-floor where it should be led through a trap.

Your water company may have requirements related to waste water - check with them prior to installation.

Support Handles

Handles secured outside the pool are advised to aid entry and exit. These should enable the hand to be above the deck of the pool. Two locations should be considered:

a)	on wall near faucet, and
b)	a floor-to-ceiling pole at the end away from drain.

Testing

Always test the pool after installation by filling to overflow, then draining the water and inspecting all the connections for leaks.

Contacting us for Support:

E: info@edelimmersys.com W: edelimmersys.com/contact